

## ELAN 410/29

**Builder:** Elan Marine  
**Designer:** Rob Humphries  
**Lying:** Swanwick  
From February

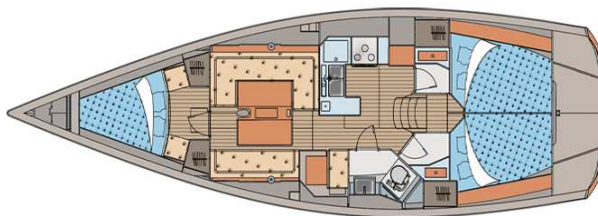

<b>Elan 410</b> (Version 1) to standard specification	118,834.00
Blue Hull	1,543.00
<b>Elan Premier Pack –</b>	4,383.00
Refrigerator	
Additional Reading Lights	
230V Sockets in each Cabin, Toilet and Saloon	
Curtain Blind Package	
Cooker and Sink Covers	
Shore Supply and Retractable Cable	
Transom Hot Water Shower	
<b>Club Racing Pack –</b>	9794.00
Aluminium Performance Mast & Spinnaker Pole	
Dyform Standing Rigging	
Dyneema Running Rigging	
Holmatro Hydraulic Back Stay Tensioner	
Harken Performance Deck Equipment and Winch Upgrade	
Folding Propeller	
<b>Performance Keel</b> (Iron Fin / Lead Bulb – 2.45m)	1,494.00
<b>Total ex VAT ex Factory Slovenia</b>	136,048.00
<b>Anti Fouling</b>	1168.00
<b>Delivery</b>	4,588.00
<b>Commissioning Pack</b>	3,326.00
<b>Sub Total</b>	145,130.00
<b>VAT @ 17.5%</b>	25,397.95
<b>Grand Total</b>	<b>170,527.75</b>

**Part exchanges considered**

Premier Yacht Sales Limited, Swanwick Marina, Southampton, Hampshire SO31 1ZL Tel:  
01489 884075 Fax: 01489 885509 [sales@premiermarinas.com](mailto:sales@premiermarinas.com) [www.premiermarinas.com](http://www.premiermarinas.com)