

|                          |                             |              |
|--------------------------|-----------------------------|--------------|
| MODEL                    | 434                         | Hull No. 290 |
| ESTIMATED HANDOVER MONTH | In Stock - Lying @ Swanwick |              |

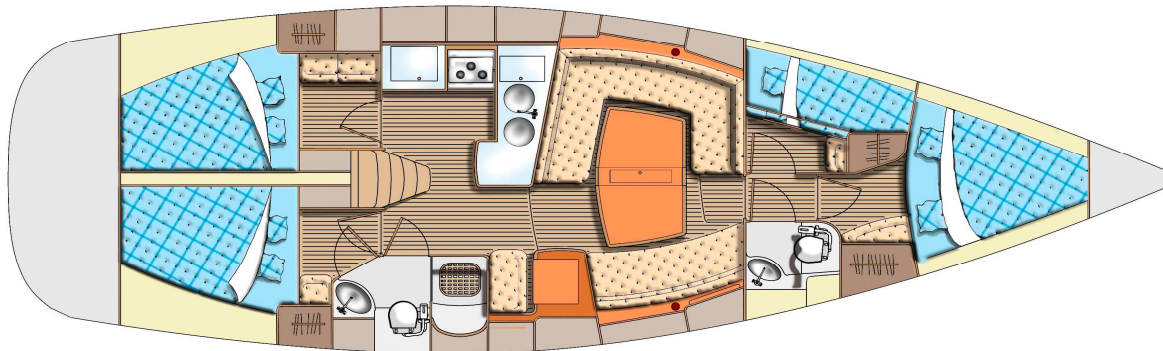

Elan Impression 434/290 is a four cabin version with a white hull and grey boot top.  
**PICTURE IS OF A SISTERSHIP**

| ITEM DESCRIPTION         |  | QTY | SUPPLIER NAME | RRP (2009) EX VAT |
|--------------------------|--|-----|---------------|-------------------|
| 1                        | Yacht to standard specification                        | 1   | Elan          | 140865            |
| 2                        | Delivery to Swanwick, Southampton or Tollesbury, Essex | 1   | Premier       | 10330             |
| 10                       | Premier pack   | 1   | Elan          | 6241              |
| 11                       | Teak on cockpit floor                                  | 1   | Elan          | Standard          |
| 12                       | Teak cockpit seats                                     | 1   | Elan          | Standard          |
| 13                       | Companionway and saloon step lights                    | 1   | Elan          | Pack              |
| 14                       | Guard rail exits                                       | 1   | Elan          | Pack              |
| 15                       | Deck light   | 1   | Elan          | Pack              |
| 19                       | Additional reading lights                              | 1   | Elan          | Pack              |
| 20                       | 230V Sockets in each cabin, toilet and saloon          | 1   | Elan          | Standard          |
| 21                       | Curtain and blind package                              | 1   | Elan          | Pack              |
| 22                       | Cooker and sink covers                                 | 1   | Elan          | Pack              |
| 23                       | Refrigerator   | 1   | Elan          | Standard          |
| 25                       | Shore supply with cable                                | 1   | Elan          | Standard          |
| 28                       | Transom hot water shower                               | 1   | Elan          | Standard          |
| 29                       | Holding tank with macerator pump                       | 1   | Elan          | Pack              |
| 30                       | Hot water system                                       | 1   | Elan          | Standard          |
| 31                       | Stove upgrade to include oven                          | 1   | Elan          | Standard          |
| 32                       | Electric shower pump out in heads                      | 1   | Elan          | Pack              |
| 33                       | Battery charger  | 1   | Elan          | Standard          |
| 66                       | Teak deck  | 1   | Elan          | 7400              |
| 69                       | Main fully battened                                    | 1   | Elan          | 1017              |
| 86                       | Harken winches   | 1   | Elan          | Standard          |
| 93                       | Rod kicker   | 1   | Elan          | Standard          |
| 95                       | Adjustable genoa cars                                  | 1   | Elan          | Standard          |
| 96                       | Mainsheet traveller on coach roof                      | 1   | Elan          | Standard          |
| 99                       | Deck light   | 1   | Elan          | Standard          |
| 102                      | Dorado vents   | 1   | Elan          | 203               |
| 108                      | Transom fender   | 1   | Elan          | Standard          |
| 109                      | Bow thruster   | 1   | Elan          | 3253              |
| 110                      | Electric windlass                                      | 1   | Elan          | 1230              |
| 112                      | Spring cleats  | 1   | Elan          | Standard          |
| 120                      | Additional berth in saloon                             | 1   | Elan          | 348               |
| 124                      | Leather upholstery (saloon only)                       | 1   | Elan          | 902               |
| 131                      | Microwave in galley                                    | 1   | Elan          | 303               |
| <b>Premier Equipment</b> |  |     |               |                   |
| 500                      | Commissioning  | 1   | Premier       | 5398              |
| 501                      | Antifouling  | 1   | Premier       | 869               |
| 600                      | ST60 Tridata system                                    | 1   | Premier       | 0                 |
| 601                      | ST60 Wind system                                       | 1   | Premier       | 508               |
| 700                      | Spray hood   | 1   | Premier       | 825               |
| 701                      | Spray hood grab handle                                 | 1   | Premier       | 181               |
| 704                      | Bimini   | 1   | Premier       | 1193              |

Premier Yacht Sales Ltd. Reserve the right at our discretion to alter prices and specification without prior notice. All weights and measures are calculated numbers based on the construction data. Changes in construction and equipment reserved. All prices are in pounds sterling and include supply and fitting to Premier Yacht Sales specification. Any variation of fitting specification may be subject to a surcharge. This price list overrides any lists that may be contained within individual manufacturers brochures for models supplied into areas for which Premier Yacht Sales Ltd. is the representative agent for that manufacturer.

|                      |                 |
|----------------------|-----------------|
| <b>Sub Total</b>     | <b>£181,065</b> |
| <b>VAT</b>           | <b>£27,160</b>  |
| <b>RRP Inc VAT</b>   | <b>£208,225</b> |
| <b>Special Offer</b> | <b>£26,500</b>  |
| <b>Total in VAT</b>  | <b>£181,725</b> |

**For further details about this yacht or others in the Elan ranges please contact -  
Tony Jones - Elan Product Manager - 07764 420 914 / tony.jones@premiermarinas.com**

